



SAVE THESE INSTRUCTIONS - READ ALL INSTRUCTIONS CAREFULLY

WARNING

CAN ICES-005 (B) NMB-005 (B)



PLEASE READ ALL INSTRUCTIONS BEFORE ATTEMPTING INSTALLATION.

- To prevent personal injury or product damage only licensed electricians/personnel should install fixture.
- To avoid electric shock or component damage disconnect power before attempting installation or servicing.
- This product must be installed in accordance with the National Electric Code (NEC) and all applicable Federal, State/Provincial and Local Electric Codes and Safety Standards.
- Disconnect fixture and allow cooling prior to servicing.
- Any alteration or modification of this product is expressly forbidden as it may cause serious personal injury, death, property damage and/or product malfunction.
- To prevent product malfunction and/or electrical shock this product must be properly grounded.
- All parts must be used as indicated in the instructions. Do not substitute any parts, leave parts out, or use any parts that are worn, damaged or broken.
- This fixture will only work with 120VAC input power supply. Any other power supply may damage or destroy it.
- Suitable for damp locations.
- Products damaged due to incorrect installation will not be covered by warranty.

WARNING - RISK OF ELECTRIC SHOCK. TURN OFF POWER SUPPLY PRIOR TO INSTALLATION.

INSTALLATION

- 1 Before installation, remove the fixture and accessories package from the carton. Remove the plastic lens from the fixture by rotating the lens until free.
- 2 Thread the enclosed screws into the J-BOX mounting holes and partially tighten them.
- 3 Pull the power supply wires out from the J-BOX. Using wire nuts, connect the black supply wire (load) to the black fixture wire // the white supply wire (neutral) to the white fixture wire // the supply ground wire to the fixture green wire. Wrap all wire nut connections with electrical tape to secure connections.
- 4 After securing all wiring connections, install the metal fixture housing to the J-BOX by sliding the housing keyless slots over the mounting screws. Rotate the fixture housing clockwise until the screws slide into the narrow ends of the keyless slots. Tighten the mounting screws.
- 5 Select the color temperature required by adjusting the dip switch. Default setting is 3000K.
- 6 Attach the plastic lens to the fixture housing by rotating the lens until it is securely in place.
- 7 When installation is complete, the fixture should appear flush to the ceiling.

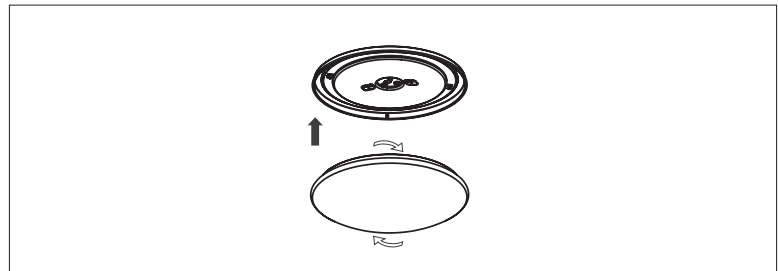
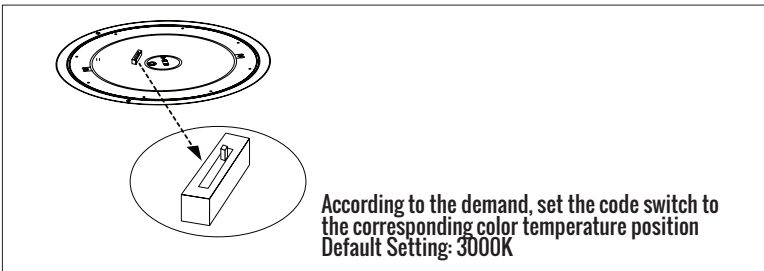
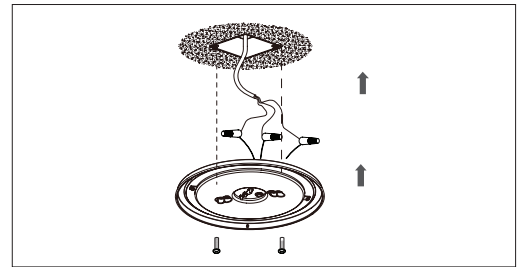
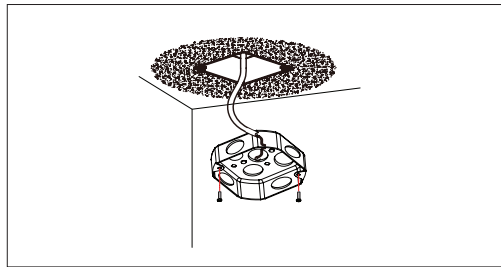
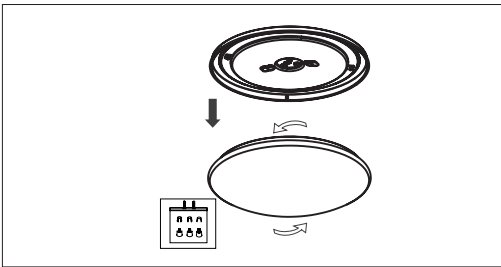

Turn on the electrical supply after completing installation. Turn the light switch on to activate the fixture.